

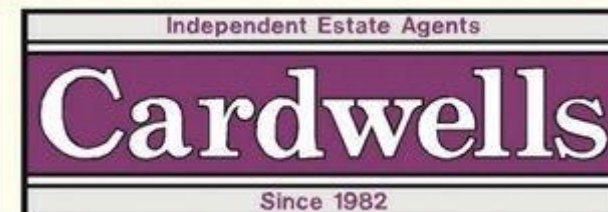

EPC

This brochure and property details are a representation of the property offered for sale or rent, as a guide only. Brochure content must not be relied upon as fact and does not form any part of a contract. Measurements are approximate. No fixtures or fittings, heating system or appliances have been tested, nor are they warranted by Cardwells or any staff member in any way as being functional or regulation compliant. Cardwells do not accept any liability for any loss that may be caused directly or indirectly by the brochure content, all interested parties must rely on their own, their surveyor's or solicitor's findings. We advise all interested parties to check with the local planning office for details of any application or decisions that may be consequential to your decision to purchase or rent any property. Any floor plans provided should be used for illustrative purposes only and should be used as such by any interested party.



www.cardwells.co.uk

Incorporating: Wright Dickson & Catlow, WDC Estates

SILVERWELL STREET, BOLTON, BL1 1PP



- BOLTON TOWN CENTRE OFFICE
- ACCOM OVER 3 LEVELS
- VERSATILE OFFICE/COMMERCIAL
- TENANTED UNTIL MARCH 2017
- CURRENT RENT £7,000 P ANNUM
- SUIT A VARIETY OF USES STPP
- EVER POPULAR PROF DISTRICT
- APPROX 1,690 SQ FT OF ACCOM



Auction Guide Price £65,000

CARDWELLS BOLTON
11 Institute Street BL1 1PZ
t: 01204 381 281
e: bolton@cardwells.co.uk

CARDWELLS BURY
14 market Street BL9 0AJ
t: 0161 761 1215
e: bury@cardwells.co.uk

WHITEFIELD/PRESTWICH
44 Bury Old Rd M45 6TL
t: 0161 773 1011
e: whitefield@cardwells.co.uk

CARDWELLS M28
6 Memorial Rd M28 3AQ
t: 0161 794 3434
e: m28@cardwells.co.uk

Fivegate Ltd. Registered in England No. 1822919 Registered Office: 44 Bury Old Road, Whitefield, Manchester, M45 6TL. Directors: R.W.L. Cardwell, A.R. Cardwell, C. Pearson

For Sale By Auction via Pugh & Co at the AJ Bell Stadium from 12.00pm on 17th October 2017 is this town centre office building with accommodation over three levels. Situated in the heart of the town centre of Bolton, this is a versatile building which is currently used as house of worship by the existing tenants. We have been advised that the current tenants pay £7,000.00 per annum in rent, and the existing tenancy agreement ends at the end of March 2018. The accommodation extends to approximately 1,690 sqft over three levels; with an open plan ground floor office / reception area, rear office, two toilets, lower level cellar, whilst to the first floor there are an additional three offices. It may be that the property would suit a variety of uses and interpretations and we would encourage interested parties to make their own enquiries with Bolton Council. Viewings can be arranged via an advanced appointment with Cardwells Estate Agents Bolton on 01204 381281 or bolton@cardwells.co.uk

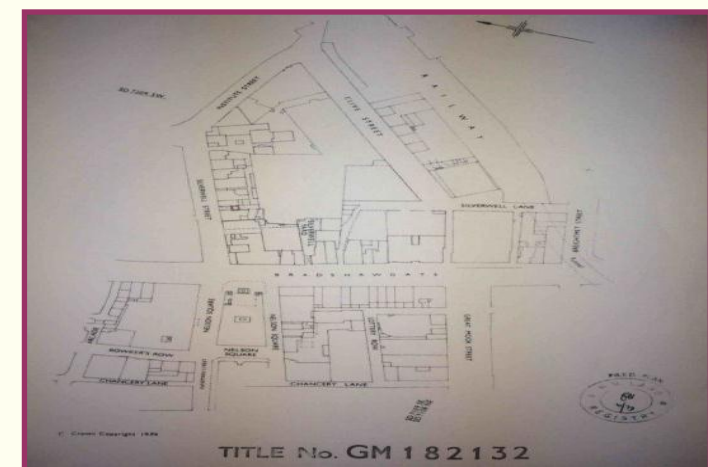
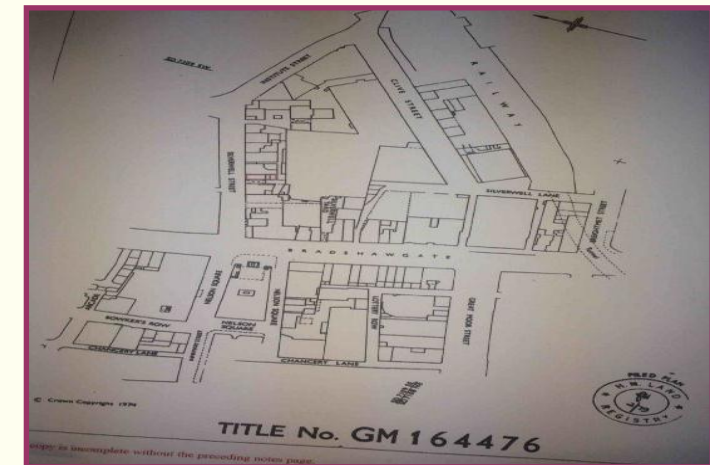

Please note: all viewings are by appointment only through our BOLTON Office